

44106 Old Warm Springs Blvd
 Fremont, CA 94538 (510) 226-9062 www.awpl.com

SINTER-1 FURNACE SPECIFICATIONS

The Markforged Sinter-1 is a high performing, high value furnace - it's affordable, sizable, and reliable. Featuring 4760 cubic cm of working volume, The Sinter-1 effortlessly converts washed parts into their dense final metallic form. Built on 30 years of Metal Injection Molding (MIM) technology, it is ideal for sintering medium sized parts and small batch production.

FURNACE PROPERTIES	Materials Supported	All Commercial Grade Metals Including: Stainless Steel, Tool Steel, Inconel, Aluminum, & Titanium
	Heating Element	Kanthal
	Controller	Pre-Programmed Automatic Cycling
	Peak Temperature	1300° C
	Sintering Capacity	Cylindrical - 141 mm ID x 305 mm L (5.55" ID x 12" L)
	Sintering Volume	4760 cubic cm (290 cubic in)
	Gas Types	Nitrogen, Argon, and Forming Gases
	Retort	High Purity Refractory Retort (Carbon Free)
	Sintering Surface	Ceramic
	SAFETY & INSTALLATION	Environmental Req.
Power		208 1-Phase 36A, Recommend Wiring 50A
Over Temperature		Protection System Included
PHYSICAL DIMENSIONS	External Dimensions	1067 mm x 483 mm x 406 mm (42" x 19" x 16")
	Weight	218 kg (500 lbs)

MACHINE COST

\$14,990

SIDE VIEW

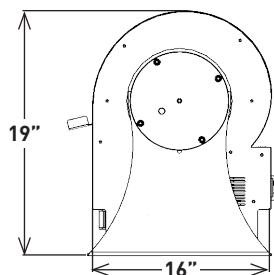

FRONT VIEW

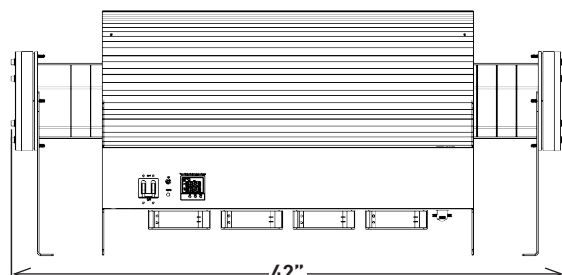

All specifications approximate and subject to change without notice.